

Use these cheat sheets to help you determine the best layout for your room shape

## Square Room Layouts

If you have a square shaped room, use these layouts to stage your living room.

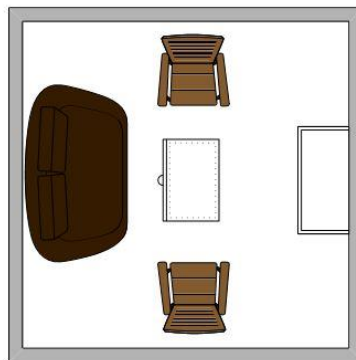
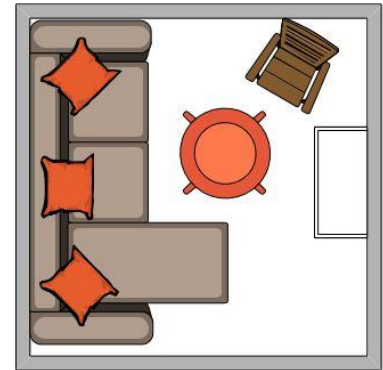
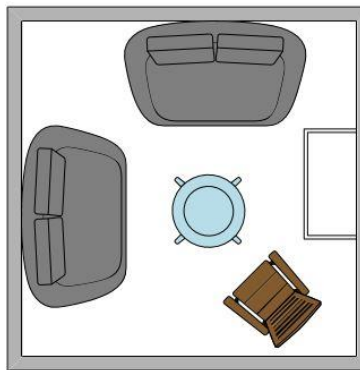
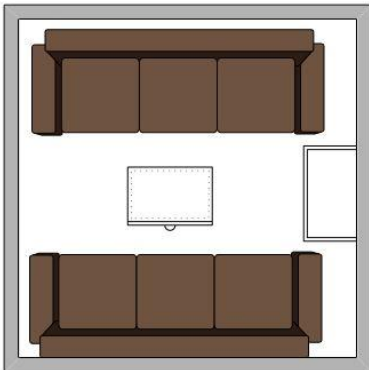
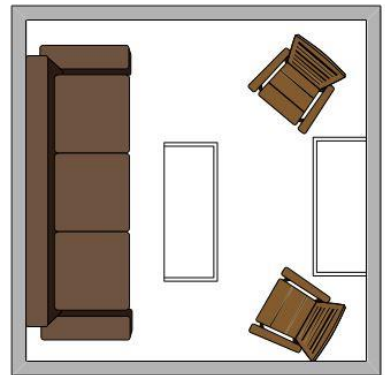
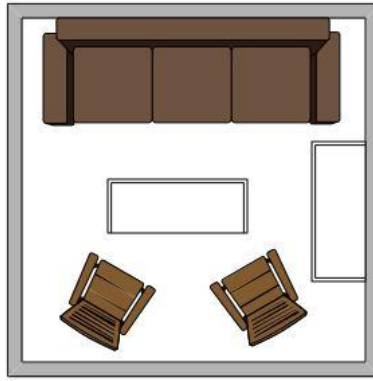
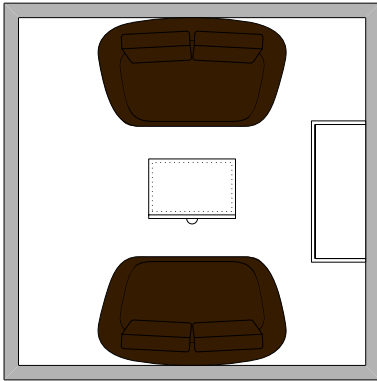

## Rectangular Room Layouts

If you have a rectangular shaped room, use these layouts to stage your living room.

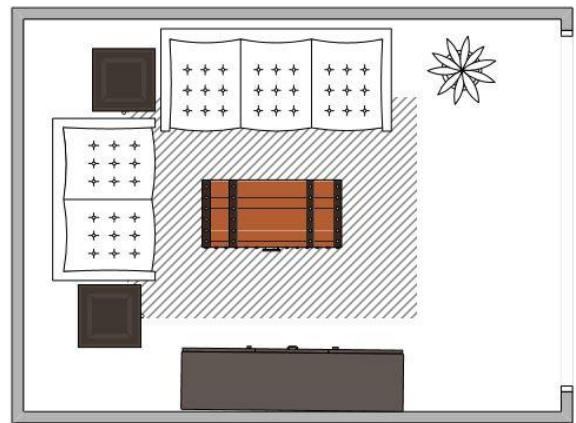
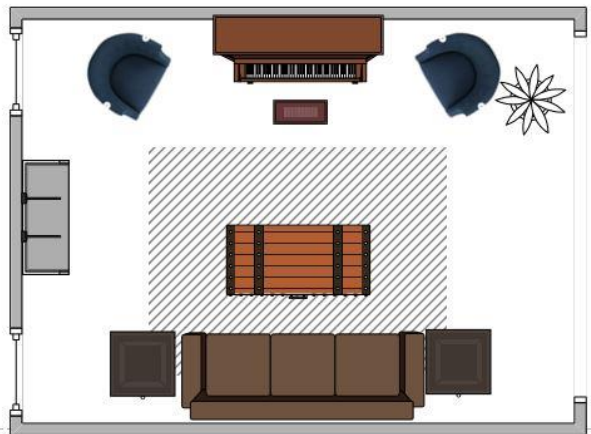
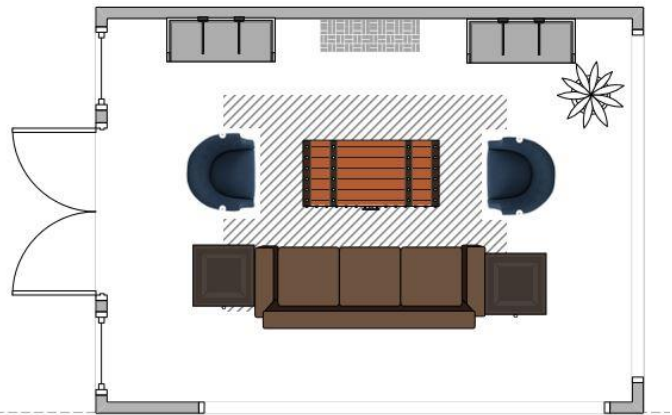
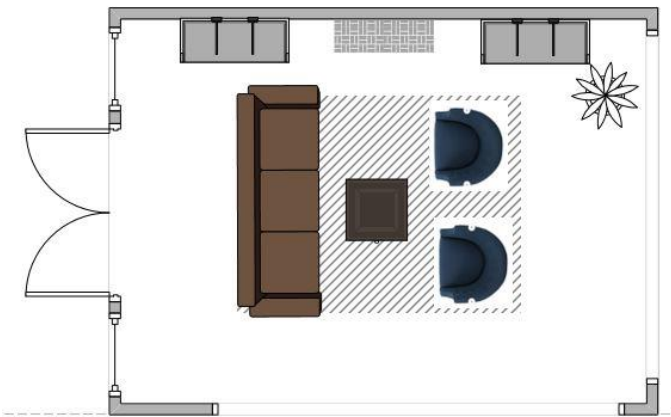
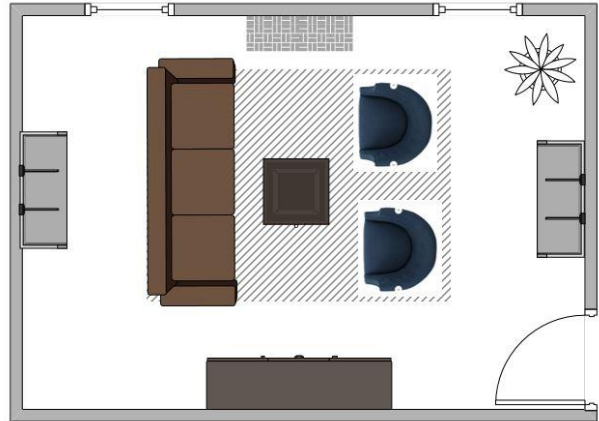
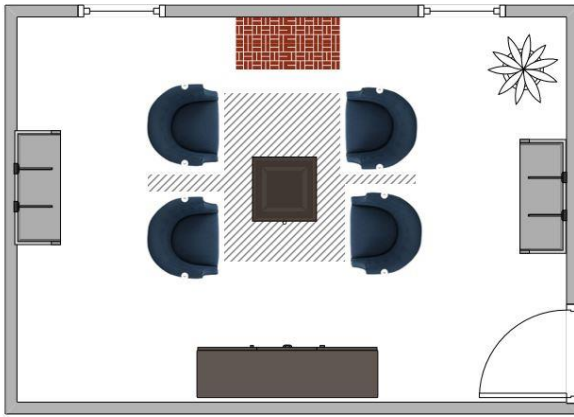

## Corner Fireplace Layouts

If you have a fireplace in the corner of your living room, use these layouts to stage your room.

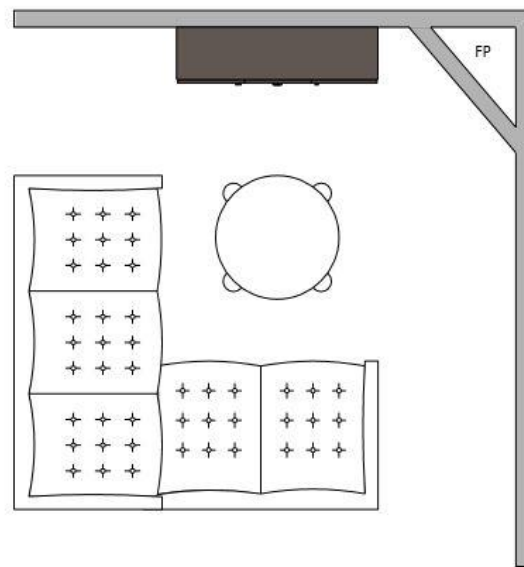
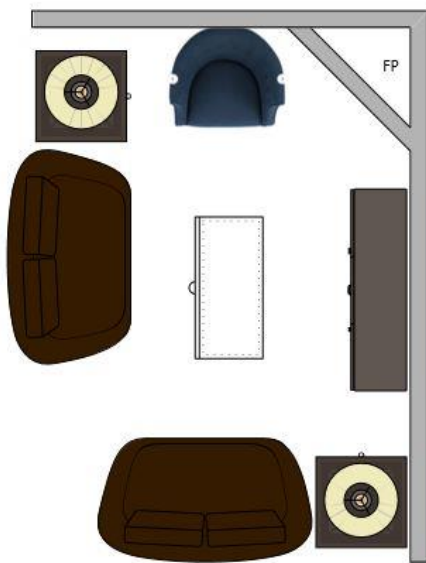
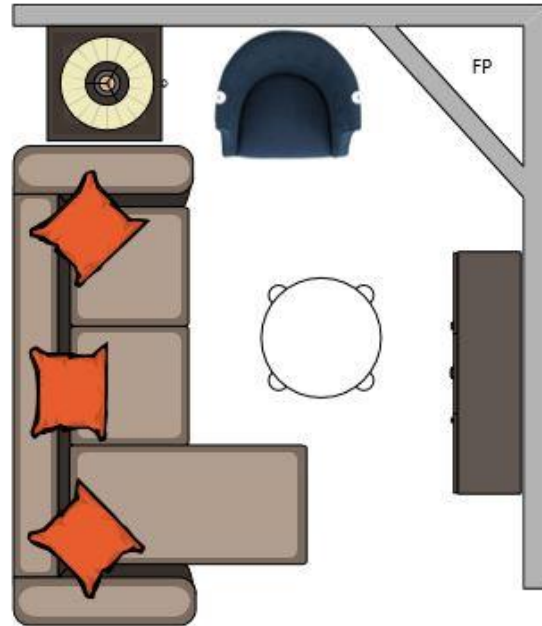
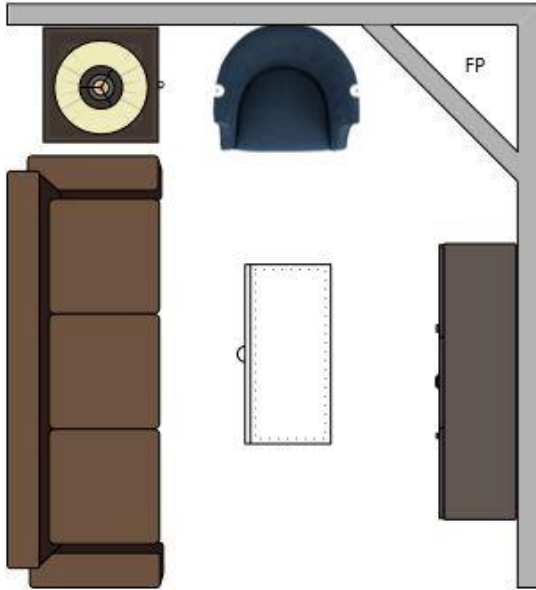

## Corner fireplace layouts continued

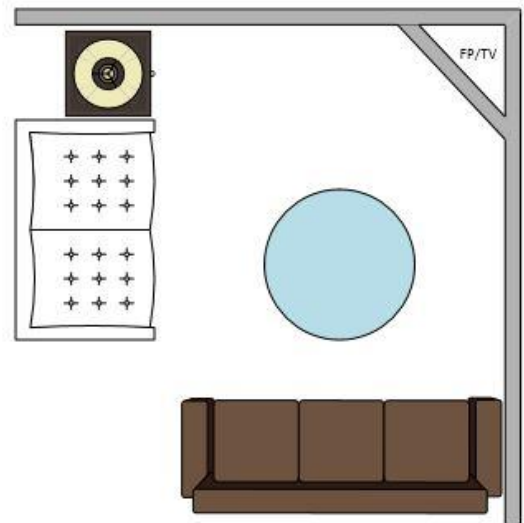
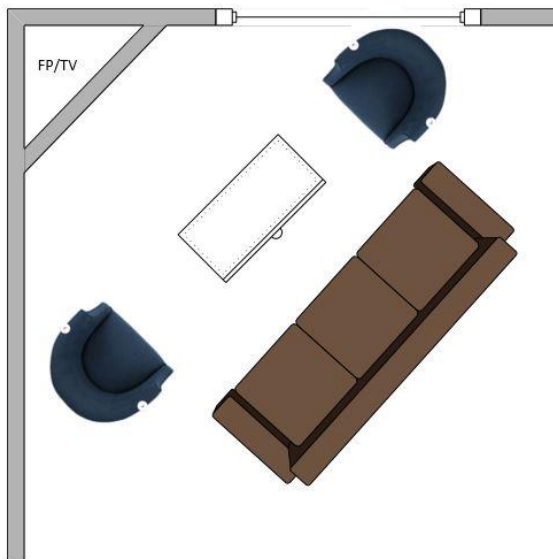
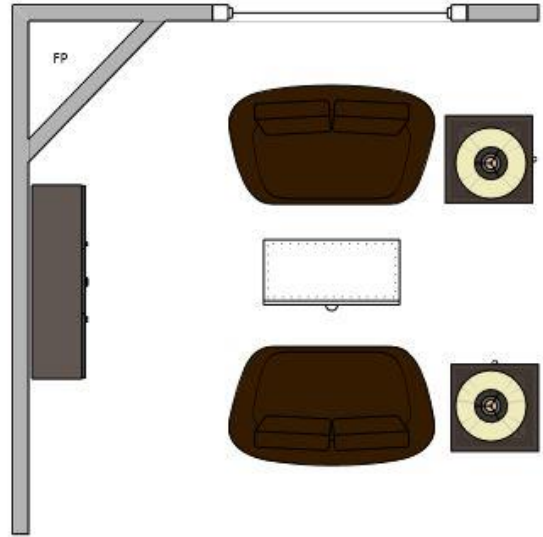
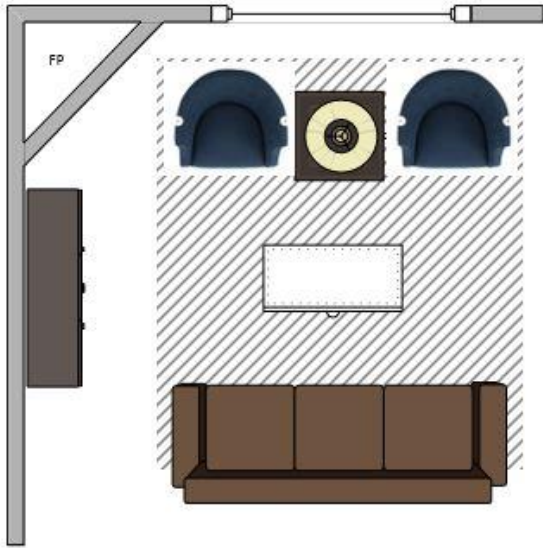

## Open Concept Rectangular Layout

Use with open layouts in your home

Think of this layout as 3 square boxes. The kitchen is 1 square. The dining area is a square and the living room is a square. Refer to the square room layout section to stage the furniture for this space.

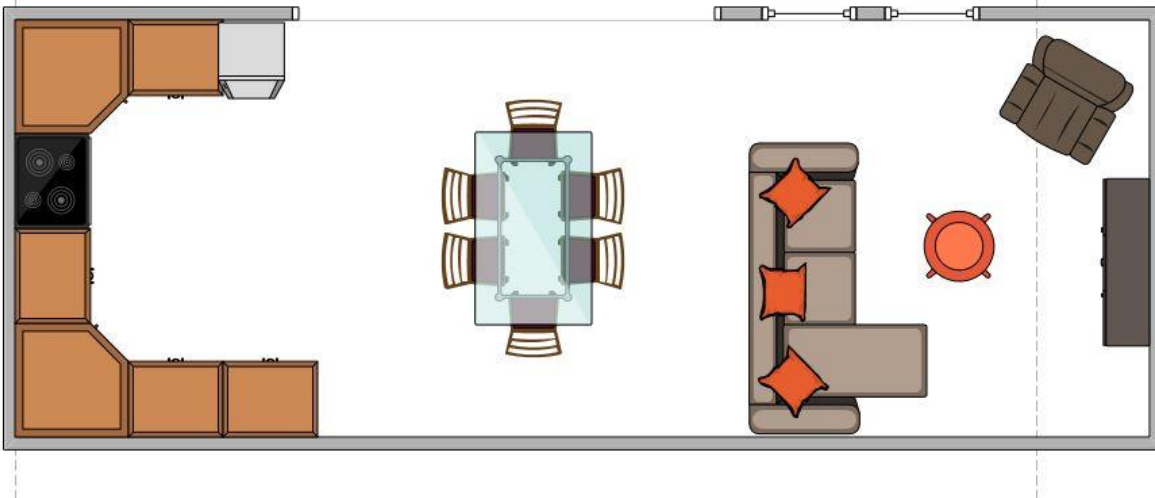

## Open Concept L-Shaped Room Layout

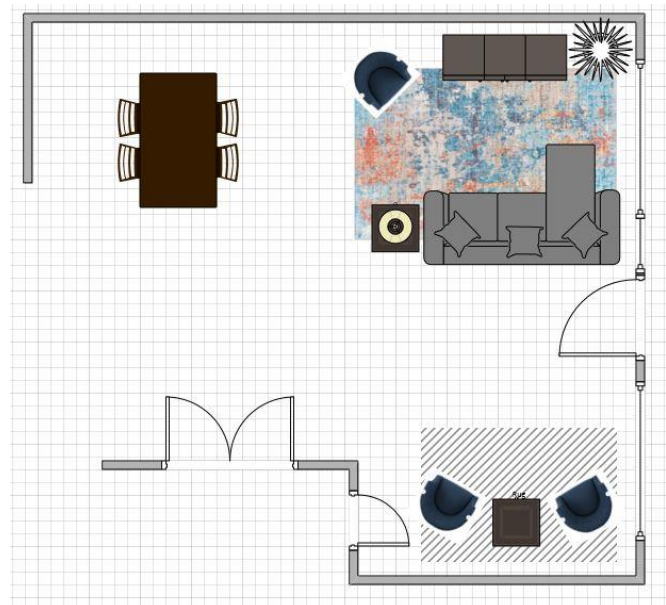

# HOW TO STAGE A LIVING ROOM WORKSHEETS

This layout is an L-shaped room but again think of these as separate square rooms.

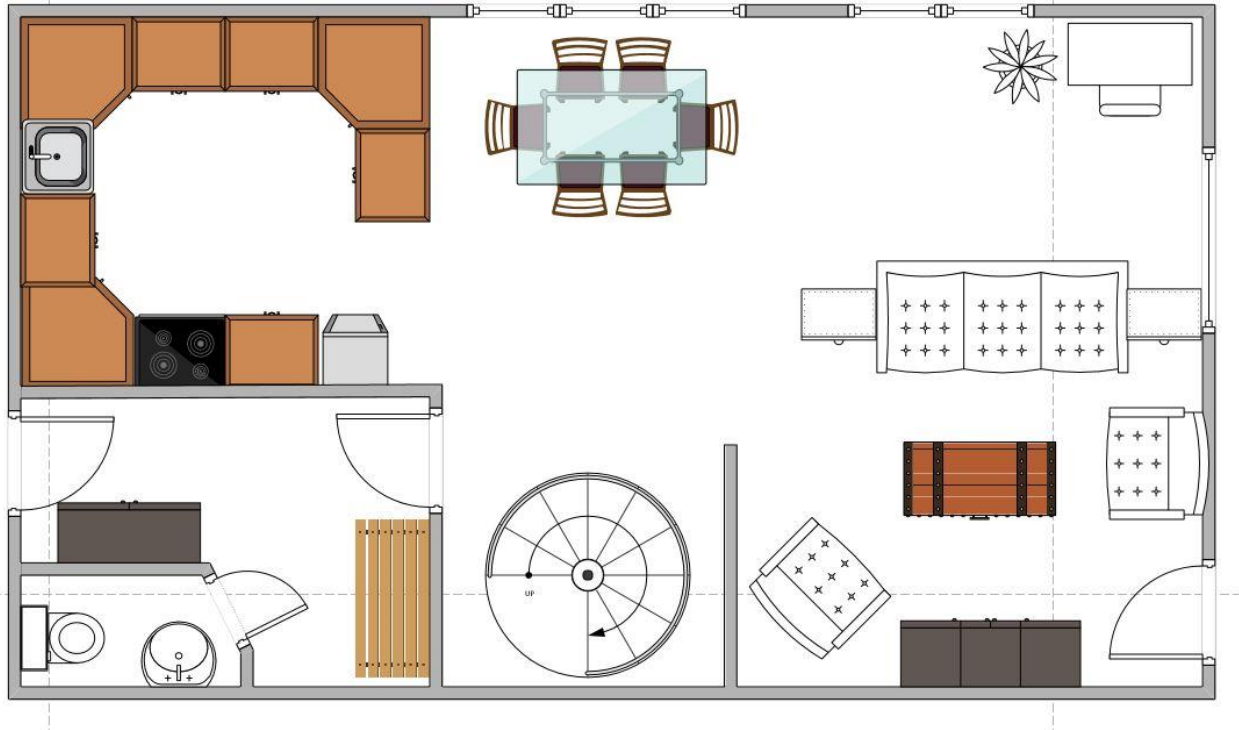



# HOW TO STAGE A LIVING ROOM WORKSHEETS

## Living Room Staging Worksheet

Room Shape: Square      Rectangular      L-Shaped      Open Concept

Focal point:    Fireplace      TV

Room Layout Selected:

Colors in room:

Fix/Replace:    Lightbulbs      Ceiling Fan      Wall/Paint      Flooring      Curtains/Blinds

Artwork Hung: Yes    No      N/A

Bookshelves staged: Yes    No      N/A

Side tables and coffee table staged: Yes    No

List Items to Remove

List Items to Add